

7. I-Beams |형강

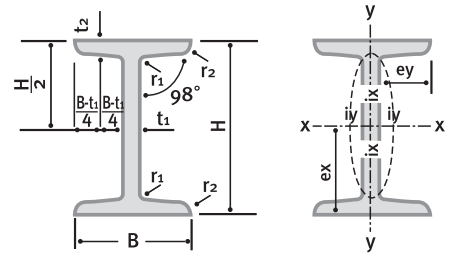

Dimensions and Sectional Properties 치수 및 단면성능

KS D 3503, 3515/3502

표준 단면 치수 Standard Sectional Dimension(mm)					단면적 Sectional Area(cm ²)	단위무게 Unit Weight (kg/m)	단면 2차 모멘트 Moment of Inertia(cm ⁴)		단면 2차 반경 Radius of Gyration(cm)		단면계수 Modulus of Section(cm ³)	
H x B	t ₁	t ₂	r ₁	r ₂	A	W	I _x	I _y	i _x	i _y	S _x	S _y
*100 x 75	5	8	7	3.5	16.43	12.9	281	47.3	4.14	1.70	56.2	12.6
*125 x 75	5.5	9.5	9	4.5	20.45	16.1	538	57.5	5.13	1.68	86	15.3
*150 x 75	5.5	9.5	9	4.5	21.83	17.1	819	57.5	6.12	1.62	109	15.3
200 x 100	7	10	10	5	33.06	26.0	2170	138	8.11	2.05	217	27.7
250 x 125	7.5	12.5	12	6	48.79	38.3	5180	337	10.3	2.63	414	53.9
300 x 150	10	18.5	19	9.5	83.47	65.5	12700	886	12.3	3.26	849	118
*300 x 150	11.5	22	23	11.5	97.88	76.8	14700	1080	12.2	3.32	978	149

Note : * 는 별도주문판매 (These sizes indicated by an asterisk(*) are not included in regular rolling schedules.)

8. I-Beams for Mine Support 광산지보용 I형강

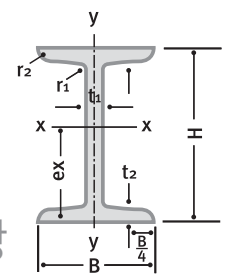

Dimensions and Sectional Properties 치수 및 단면성능

KS E 4002

표준 단면 치수 Standard Sectional Dimension(mm)					단면적 Sectional Area(cm ²)	단위무게 Unit Weight (kg/m)	단면 2차 모멘트 Moment of Inertia(cm ⁴)		단면 2차 반경 Radius of Gyration(cm)		단면계수 Modulus of Section(cm ³)	
H x B	t ₁	t ₂	r ₁	r ₂	A	W	I _x	I _y	i _x	i _y	S _x	S _y
100 x 80	9	12.5	13	4	26.4	20.7	403	80.5	3.91	1.75	80.7	21.1
130 x 100	12	17	16	7	44.6	35.0	1.130	211	5.05	2.18	175	42.3